

PLAT OF SURVEY FOR LOT LINE ADJUSTMENT

PART OF LOTS 6 & 7 OF UNRECORDED ANNTROYEEN ESTATES
PART OF THE SOUTHEAST 1/4 OF SECTION 12
AND THE NORTHEAST 1/4 OF SECTION 13,
TOWN 4 NORTH, RANGE 17 EAST,
TOWN OF TROY, WALWORTH COUNTY, WISCONSIN

NORTH 1/4 CORNER
SEC. 13-4-17

LEGAL DESCRIPTION LANDS SURVEYED

LOT 7 OF UNRECORDED ANNTROYEEN ESTATES, LOCATED IN PART OF THE NE 1/4 OF SECTION 13, TOWN 4 NORTH, RANGE 17 EAST, TOWN OF TROY, WALWORTH COUNTY, WISCONSIN;
EXCEPTING THEREFROM:
COMMENCING AT THE NORTH 1/4 CORNER OF SAID SECTION 13; THENCE S 46DEG 38MIN 12SEC E, 680.00 FEET ALONG THE NORTHERLY LINE OF LOT 7, UNRECORDED ANNTROYEEN ESTATES TO AN IRON PIPE STAKE; THENCE S 03DEG 02MIN 50SEC W, 77.55 FEET TO AN IRON PIPE STAKE; THENCE S 52DEG 47MIN 21SEC W, 199.11 FEET TO THE POINT OF BEGINNING; THENCE S 88DEG 20MIN 40SEC W, 13.72 FEET TO AN IRON PIPE STAKE; THENCE S 58DEG 50MIN 50SEC W, 93.50 FEET TO AN IRON PIPE STAKE; THENCE S 42DEG 23MIN 03SEC W, 74.41 FEET; THENCE N 52DEG 47MIN 21SEC E, 178.39 FEET TO THE POINT OF BEGINNING.
AND INCLUDING:
COMMENCING AT THE NORTH 1/4 CORNER OF SAID SECTION 13; THENCE S 46DEG 38MIN 12SEC E, 680.00 FEET ALONG THE NORTHERLY LINE OF LOT 7, UNRECORDED ANNTROYEEN ESTATES TO AN IRON PIPE STAKE; THENCE S 03DEG 02MIN 50SEC W, 77.55 FEET TO AN IRON PIPE STAKE; THENCE S 52DEG 47MIN 21SEC W, 377.50 FEET TO THE POINT OF BEGINNING; THENCE S 52DEG 47MIN 21SEC W, 210.09 FEET; THENCE N 53DEG 05MIN 35SEC E, 204.17 FEET TO AN IRON PIPE STAKE; THENCE N 42DEG 23MIN 03SEC E, 6.02 FEET TO THE POINT OF BEGINNING.
AND ALSO INCLUDING:
COMMENCING AT THE NORTH 1/4 CORNER OF SAID SECTION 13; THENCE S 46DEG 38MIN 12SEC E, 680.00 FEET ALONG THE NORTHERLY LINE OF LOT 7, UNRECORDED ANNTROYEEN ESTATES TO AN IRON PIPE STAKE; THENCE S 03DEG 02MIN 50SEC W, 77.55 FEET TO AN IRON PIPE STAKE AND THE POINT OF BEGINNING; S 52DEG 47MIN 21SEC W, 189.11 FEET; THENCE N 68DEG 20MIN 40SEC E, 43.78 FEET TO AN IRON PIPE STAKE; THENCE N 48DEG 30MIN 42SEC E, 157.37 FEET TO THE POINT OF BEGINNING.

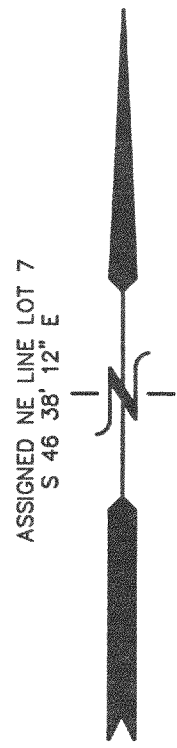

LOT 8

LOT 7
AREA = 5.38 ACRES

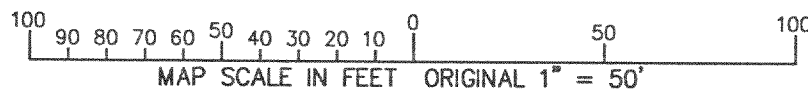

- LEGEND
- - FOUND IRON PIPE
 - - FOUND IRON REBAR
 - ⊕ - FOUND CONCRETE MONUMENT
 - () - RECORDED AS
 - SET IRON REBAR STAKE

LEGAL DESCRIPTION LOT LINE ADJUSTMENT PARCELS

PARCEL "A"
PART OF LOT 7 OF UNRECORDED ANNTROYEEN ESTATES, TO BECOME APPURTENANT TO LOT 6 OF SAID SUBDIVISION, LOCATED IN PART OF THE NE 1/4 OF SECTION 13, TOWN 4 NORTH, RANGE 17 EAST, TOWN OF TROY, WALWORTH COUNTY, WISCONSIN, DESCRIBED AS FOLLOWS:
COMMENCING AT THE NORTH 1/4 CORNER OF SAID SECTION 13; THENCE S 01DEG 23MIN 49SEC E, 900.00 FEET TO THE POINT OF BEGINNING AT THE SOUTHWEST CORNER OF SAID LOT 7; THENCE N 52DEG 42MIN 51SEC E, 24.68 FEET; THENCE S 01DEG 24MIN 27SEC E, 262.34 FEET; THENCE S 88DEG 35MIN 33SEC W, 20.00 FEET TO THE WEST LINE OF SAID LOT 6; THENCE N 01DEG 24MIN 27SEC W, 247.88 FEET TO THE POINT OF BEGINNING. CONTAINING 5102 SQUARE FEET OF LAND MORE OR LESS.

PARCEL "B"
PART OF LOT 6 OF UNRECORDED ANNTROYEEN ESTATES, TO BECOME APPURTENANT TO LOT 7 OF SAID SUBDIVISION, LOCATED IN PART OF THE NE 1/4 OF SECTION 13, TOWN 4 NORTH, RANGE 17 EAST, TOWN OF TROY, WALWORTH COUNTY, WISCONSIN, DESCRIBED AS FOLLOWS:
COMMENCING AT THE NORTH 1/4 CORNER OF SAID SECTION 13; THENCE S 01DEG 23MIN 49SEC E, 900.00 FEET TO THE SOUTHWEST CORNER OF SAID LOT 7; THENCE N 52DEG 42MIN 51SEC E, 24.68 FEET TO THE POINT OF BEGINNING; THENCE N 44DEG 20MIN 28SEC E, 169.53 FEET; THENCE N 55DEG 49MIN 28SEC E, 161.21 FEET; THENCE N 65DEG 57MIN 59SEC E, 77.07 FEET; THENCE N 52DEG 19MIN 23SEC E, 159.19 FEET TO THE NORTHWEST CORNER OF SAID LOT 6 AND KITTY COURT; THENCE S 48DEG 40MIN 15SEC W, 157.32 FEET; THENCE S 73DEG 23MIN 39SEC W, 57.52 FEET; THENCE S 56DEG 04MIN 48SEC W, 93.49 FEET; THENCE S 42DEG 34MIN 25SEC W, 80.42 FEET; THENCE S 52DEG 42MIN 51SEC W, 179.65 FEET TO THE POINT OF BEGINNING. CONTAINING 5102 SQUARE FEET OF LAND MORE OR LESS.

NOTE: THIS LOT LINE ADJUSTMENT BETWEEN ADJOINING LAND OWNERS DOES NOT CREATE ADDITIONAL LOTS AND THE ORIGINAL PARCELS ARE NOT REDUCED BELOW THE MINIMUM SIZE REQUIRED BY THE WALWORTH COUNTY ZONING ORDINANCES.

NOTE: COPIES OF THIS MAP TO WHICH THE FOLLOWING CERTIFICATE WILL APPLY SHOW SURVEYOR'S ORIGINAL SEAL AND SIGNATURE IN RED INK. COPIES BY ANY OTHER MEANS MAY HAVE ALTERATIONS WHICH DO NOT REPRESENT THE SURVEYOR'S WORK PRODUCT.

I HEREBY CERTIFY THAT THE ABOVE DESCRIBED PROPERTY HAS BEEN SURVEYED UNDER MY DIRECTION AND THAT THE ABOVE MAP IS A TRUE REPRESENTATION THEREOF AND SHOWS THE SIZE AND LOCATION OF THE PROPERTY AND ITS EXTERIOR BOUNDARIES. THIS SURVEY IS MADE FOR THE USE OF THE PRESENT OWNERS OF THE PROPERTY, AND ALSO THOSE WHO PURCHASE, MORTGAGE, OR GUARANTEE THE TITLE THERETO WITHIN ONE YEAR FROM THE DATE HEREOF.

DATED: 7-31-2001

PETER S. GORDON R.L.S. 2101

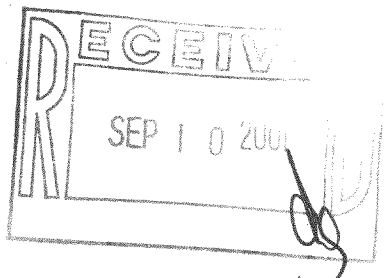

LOT LINE ADJUSTMENT
PARCEL "A"
TO BECOME APPURTENANT TO
LOT 7
5102 S.F.

LOT LINE ADJUSTMENT
PARCEL "B"
TO BECOME APPURTENANT TO
LOT 6
5102 S.F.

LOT 6
5.74 ACRES

(N 89°29'30" E)
(277.43)

FARRIS, HANSEN & ASSOCIATES, INC.

ENGINEERING — ARCHITECTURE — SURVEYING

7 RIDGWAY COURT P.O. BOX 437
ELKHORN, WISCONSIN 53121

OFFICE: (262) 723-2098 FAX: (262) 723-5886

WORK ORDERED BY:
LARRY WRUCK
W2670 KITTY COURT
EAST TROY, WI.

WORK ORDERED BY:
ROGER BORD
W2667 KITTY COURT
EAST TROY, WI.

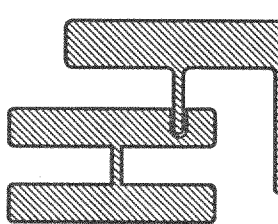

REVISIONS

PROJECT NO.
5821
DATE
07-31-01
SHEET NO.
1 OF 1

LAS-6
LAN-7
417-643